

MOTORE TORQUE - MK-CI 290-050 WA

Specifiche Motore	Simbolo	Unità	
Numero di poli	P		66
Coppia di Picco	T_{pk}	Nm	433
Coppia Continuativa (Raff. Liquido Dt100)	T_{wc}	Nm	227
Coppia Continuativa (Raff. Aria Dt100)	T_{ac}	Nm	96
Coppia di Stallo (Raff. Liquido)	T_{wsc}	Nm	173
Coppia di Stallo (Raff. Aria)	T_{sac}	Nm	73
Ripple di Coppia (Cogging)	T_r	Nm	2
Potenza Dissipata (Raff. Liquido)	P_{wc}	Kw	2,35
Potenza Dissipata (Raff. Aria)	P_{ac}	Kw	0,45
Resistenza Termica (Raff. Liquido)	R_{thWc}	Kw	0,05
Resistenza Termica (Raff. Aria)	R_{thAc}	Kw	0,26
Costante di Coppia	K_t	Nm/a	13,5
Costante di tensione	K_e	V/1000 Rpm	827
Massima Velocità a I_{pk} a 600 Vdc	N_{pk}	rpm	180
Massima Velocità a I_{wc} a 600 Vdc	N_{wc}	rpm	370
Massima Velocità a I_{ac} a 600 Vdc	N_{ac}	rpm	460
Resistenza (Fase-Fase)	R_{20}	Ω	3,9
Induttanza (Fase-Fase)	L	mh	10,8
Corrente di Picco	I_{pk}	Arms	46
Corrente continuativa (Raff. Liquido Dt100)	I_{vc}	Arms	17
Corrente Continuativa (Raff. Aria Dt100)	I_{ac}	Arms	7,4
Corrente di Stallo 0 Rpm (Raff. Liquido)	I_{swc}	Arms	12,9
Corrente di Stallo 0 Rpm (Raff. Aria)	I_{sac}	Arms	5,6
Massima temperatura di avvolgimento		$^{\circ}C$	130
Altezza del Rotore		mm	50
Altezza dello statore		mm	90
Diametro esterno statore		mm	310

Diagramma di coppia

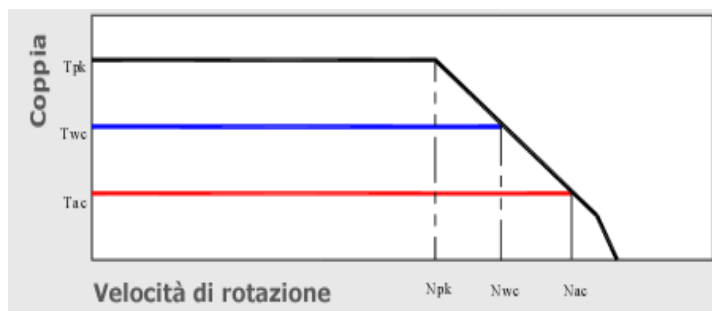

MOTORE TORQUE - MK-CI 290-050 WB

Specifiche Motore	Simbolo	Unità	
Numero di poli	P		66
Coppia di Picco	T _{pk}	Nm	432
Coppia Continuativa (Raff. Liquido Dt100)	T _{wc}	Nm	227
Coppia Continuativa (Raff. Aria Dt100)	T _{ac}	Nm	96
Coppia di Stallo (Raff. Liquido)	T _{wsc}	Nm	173
Coppia di Stallo (Raff. Aria)	T _{sac}	Nm	73
Ripple di Coppia (Cogging)	Tr	Nm	1,7
Potenza Dissipata (Raff. Liquido)	P _{wc}	Kw	2,35
Potenza Dissipata (Raff. Aria)	P _{ac}	Kw	0,45
Resistenza Termica (Raff. Liquido)	R _{thWc}	Kw	0,05
Resistenza Termica (Raff. Aria)	R _{thAc}	Kw	0,26
Costante di Coppia	K _t	Nm/a	6,75
Costante di tensione	K _e	V/1000 Rpm	413
Massima Velocità a I _{pk} a 600 Vdc	N _{pk}	rpm	450
Massima Velocità a I _{wc} a 600 Vdc	N _{wc}	rpm	850
Massima Velocità a I _{ac} a 600 Vdc	N _{ac}	rpm	960
Resistenza (Fase-Fase)	R ₂₀	Ω	1
Induttanza (Fase-Fase)	L	mh	2,7
Corrente di Picco	I _{pk}	Arms	92
Corrente continuativa (Raff. Liquido Dt100)	I _{wc}	Arms	34,2
Corrente Continuativa (Raff. Aria Dt100)	I _{ac}	Arms	14,5
Corrente di Stallo 0 Rpm (Raff. Liquido)	I _{wsc}	Arms	26
Corrente di Stallo 0 Rpm (Raff. Aria)	I _{sac}	Arms	11,1
Massima temperatura di avvolgimento		°C	130
Altezza del Rotore		mm	50
Altezza dello statore		mm	90
Diametro esterno statore		mm	310

Diagramma di coppia

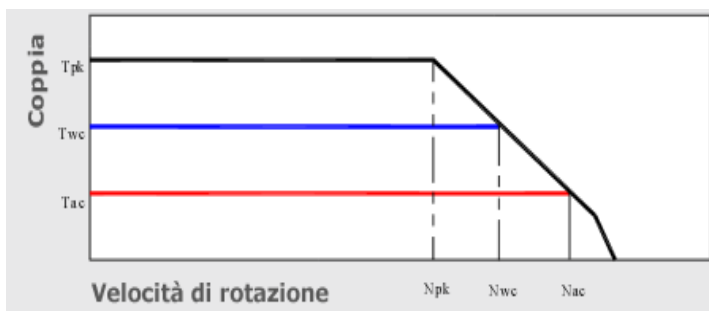

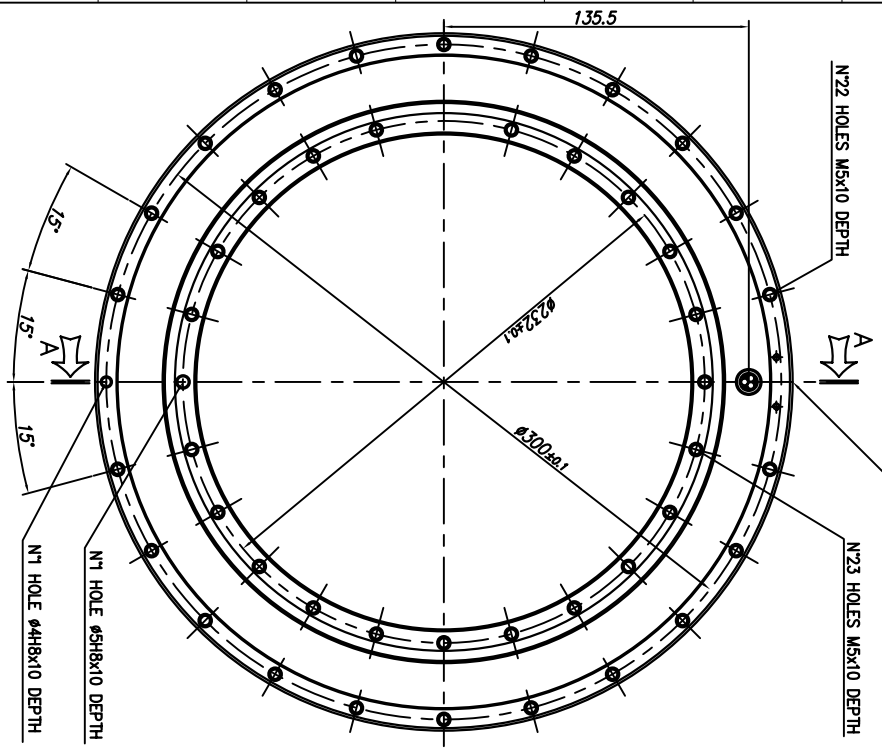

Water Cooling IN
Water Cooling OUT

SECTION "A-A"

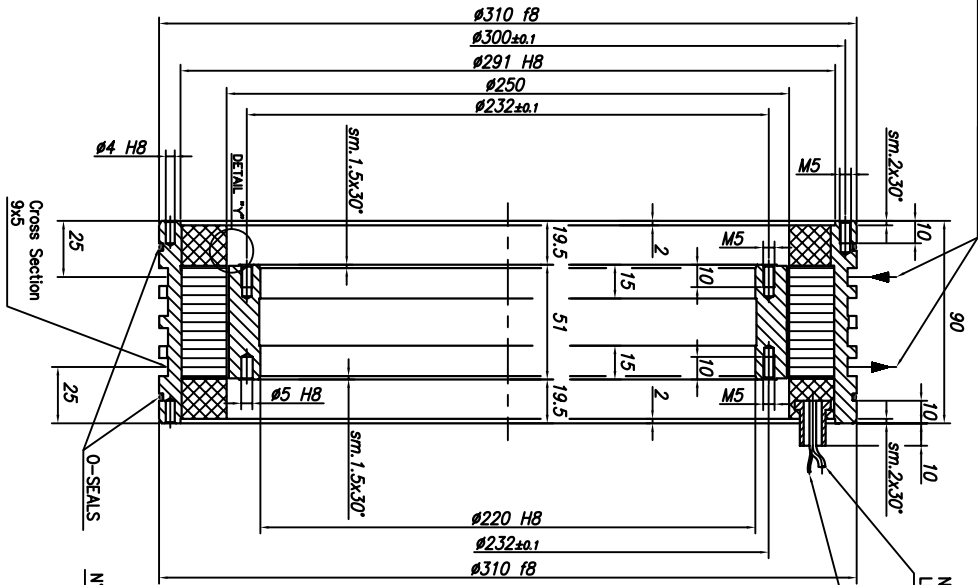

N3 MOTOR CABLE ϕ 3
LENGTH 1 mt

N6 SENSOR CABLE ϕ 6
LENGTH 1 mt

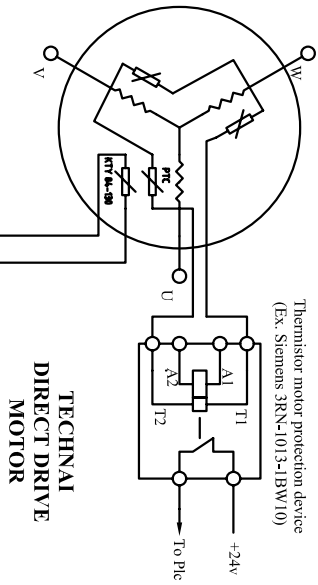
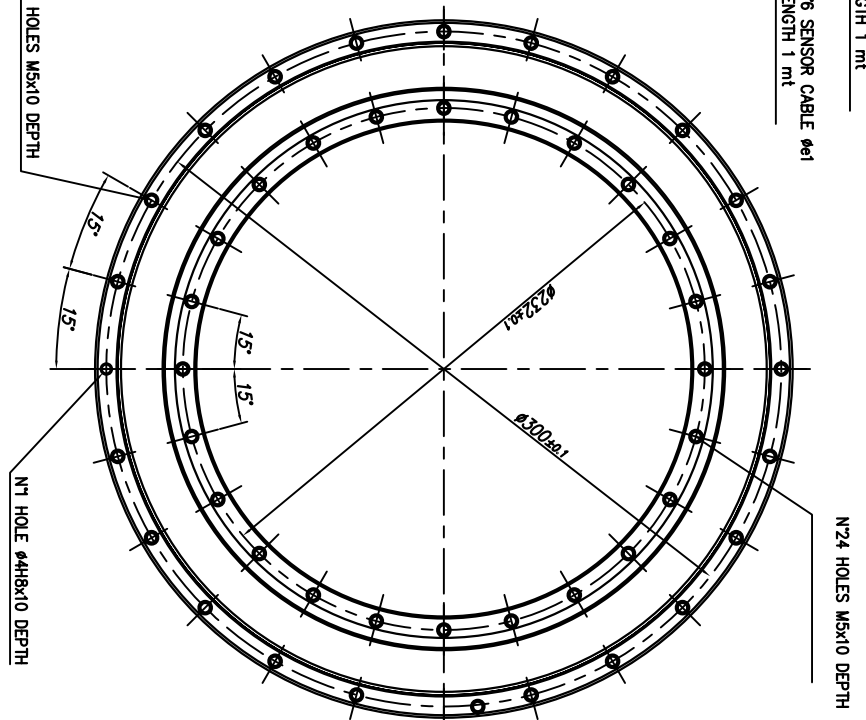

TECHNAI
DIRECT DRIVE
MOTOR

To Drive with KTY 84 input (Ex. Simodrive 611D/U) or multimeter with the appropriate rating

Thermistor motor protection device
(Ex: Siemens 3RN-1013-1BW10)

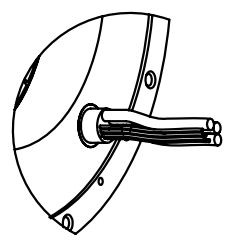

CABLE OUTPUT
CONFIGURATION
MF

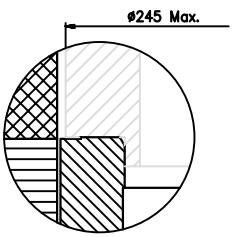

DETAIL "M"
ROTOR INTERFACE TO
CUSTOMER SHAFT

REV	DATE	BY	CHK	APP
1				
TECHNAI ROTOR-STATOR KIT MK-CI 290 MK-CI 290-050 MF				
GENERAL ASSEMBLY				
SHEET 1 OF 1				

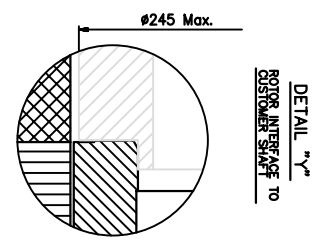
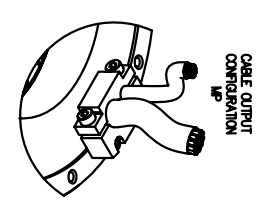
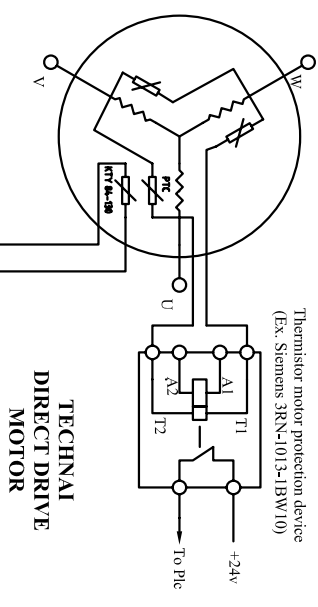
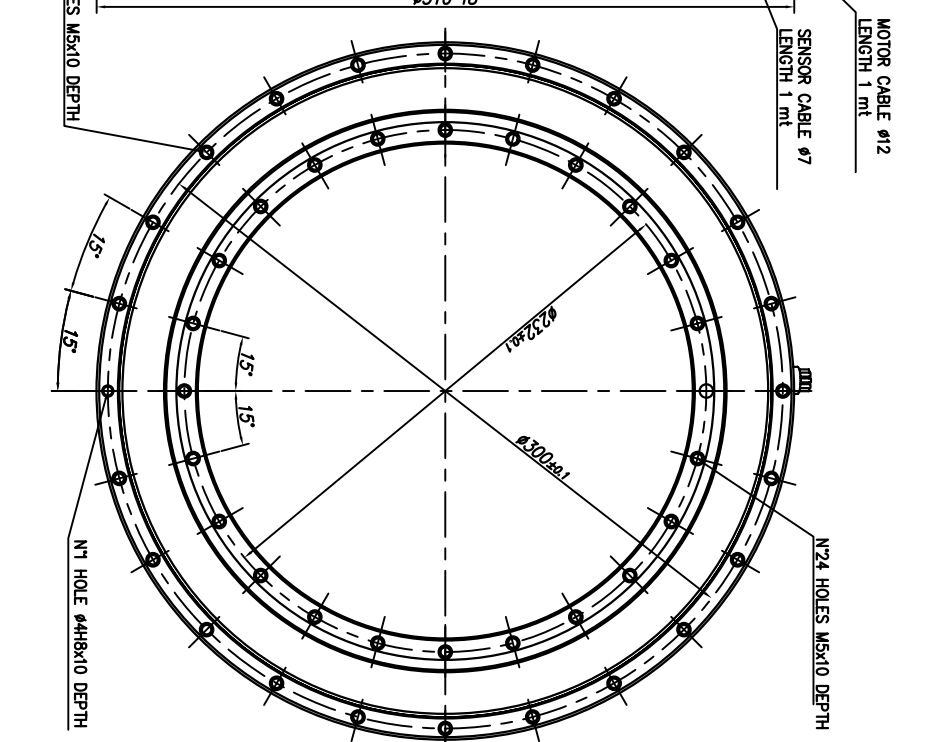
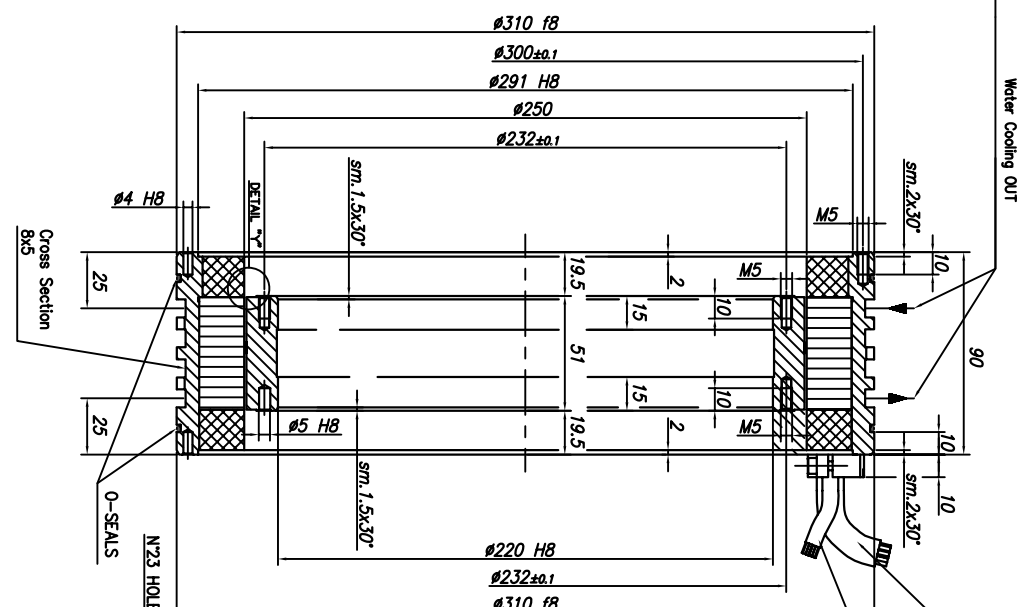
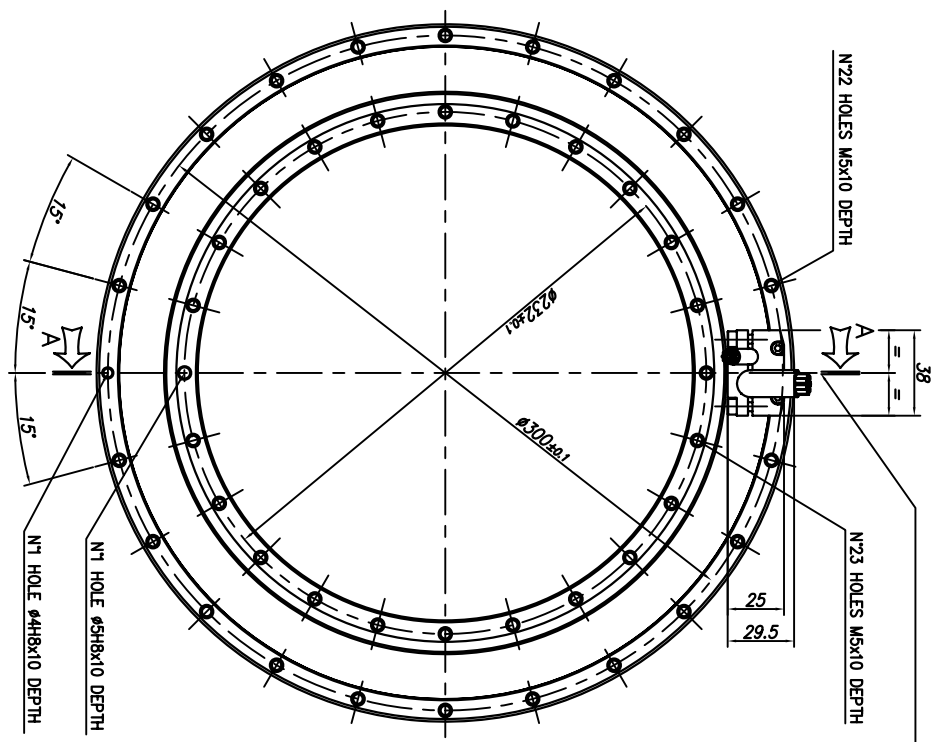

TECHNAI ROTOR-STATOR KIT MK-CI 290 MK-CI 290-050 MPF		GENERAL ASSEMBLY SHEET 1 OF 1	
1. NAME 2. PART NUMBER 3. REV. NO. 4. DATE	5. QUANTITY 6. UNIT 7. DRAWN BY 8. CHECKED BY 9. APPROVED BY	10. MATERIAL 11. FINISH 12. TOLERANCES 13. DIMENSIONS	14. COMMENTS 15. NOTES 16. REVISIONS

SECTION "A-A"

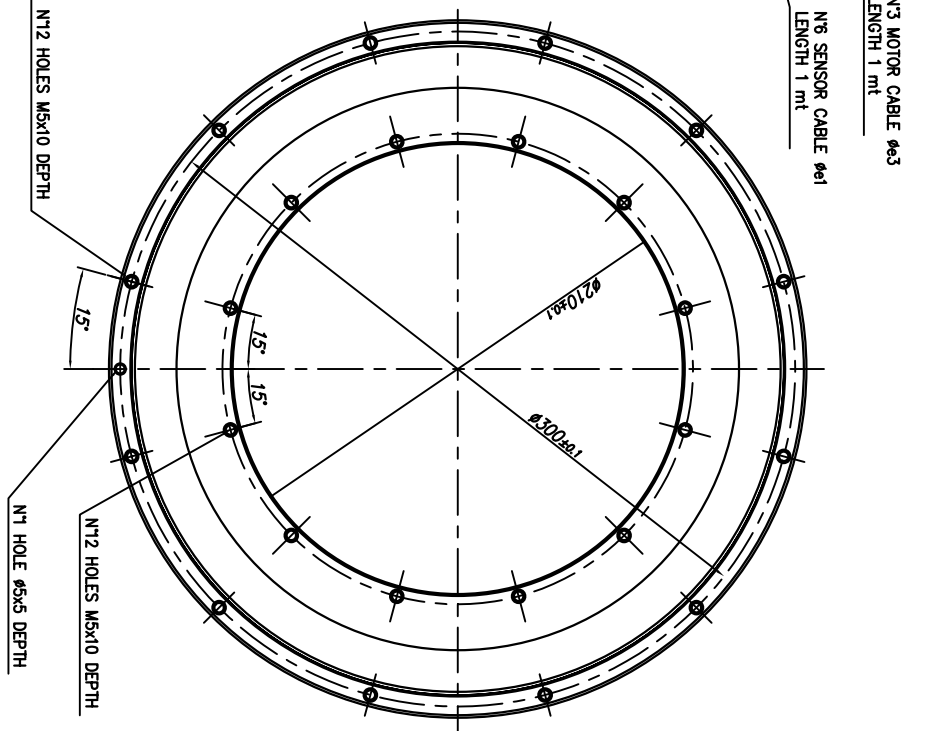
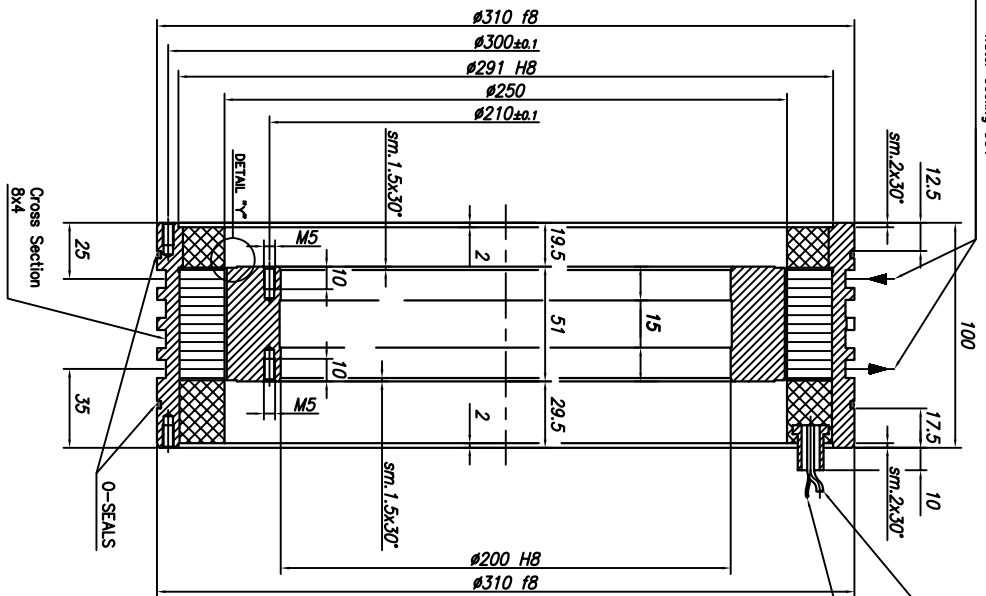
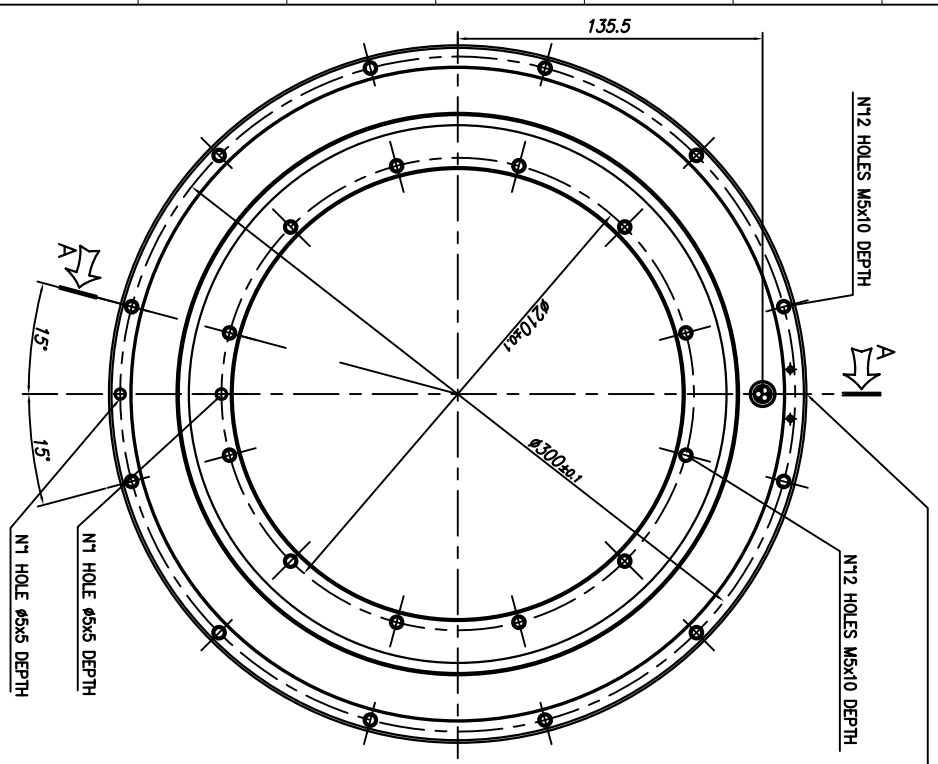

Water Cooling IN
Water Cooling OUT

N°3 MOTOR CABLE $\phi 6.3$
LENGTH 1 mt
N°6 SENSOR CABLE $\phi 6.1$
LENGTH 1 mt

CABLE OUTPUT
CONFIGURATION
MF

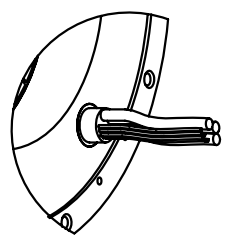

DETAIL "Y-Y"
ROTOR INTERFERENCE TO
CUSTOMER SHAFT

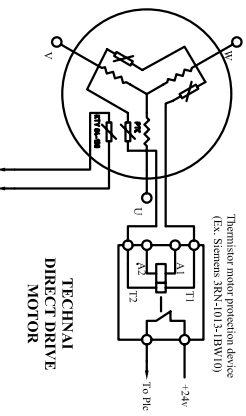
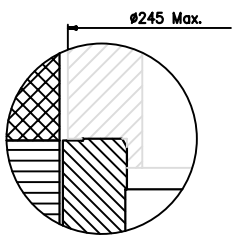

Thermistor motor protection device
(Ex. Siemens 3RN-1012-1BW10)

To Drive with KTY 84 Input (Ex. Siemens 611D10) or millimeter with the appropriate wiring

GENERAL ASSEMBLY	
ITEM	DESCRIPTION
1	ROTOR-STATOR KIT MK-CI 2905
2	MK-CI 2905-050 MF
3	...
4	...
5	...
6	...
7	...
8	...
9	...
10	...
11	...
12	...
13	...
14	...
15	...
16	...
17	...
18	...
19	...
20	...
21	...
22	...
23	...
24	...
25	...
26	...
27	...
28	...
29	...
30	...
31	...
32	...
33	...
34	...
35	...
36	...
37	...
38	...
39	...
40	...
41	...
42	...
43	...
44	...
45	...
46	...
47	...
48	...
49	...
50	...

