

TORQUE MOTOR - MK-CI 990-050 WA

Motor specification	Symbol	Unit	
Number of pole	P		176
Peak Torque	T _{pk}	Nm	6700
Continuos Torque (Water Cooling Dt100)	T _{wc}	Nm	3622
Continuos Torque (Air Cooling Dt100)	T _{ac}	Nm	1724
Stall Torque (Water Cooling)	T _{wsc}	Nm	2764
Stall Torque (Air Cooling)	T _{sac}	Nm	1316
Ripple Torque (Cogging Torque)	T _r	Nm	21
Power Loss at T _{wc}	P _{wc}	Kw	7,7
Power Loss at T _{ac}	P _{ac}	Kw	1,6
Termal Resistance Water Cooling	R _{thWc}	Kw	0,01
Termal Resistance Air Cooling	R _{thAc}	Kw	0,06
Torque Constant	K _t	Nm/a	83,4
Back EMF Constant	K _e	V/1000 Rpm	5041
Maximum Speed at I _{pk} at 600 Vdc	N _{pk}	rpm	17
Maximum Speed at I _{wc} at 600 Vdc	N _{wc}	rpm	43
Maximum Speed at I _{ac} at 600 Vdc	N _{ac}	rpm	63
Winding Resistance (Phase to Phase)	R ₂₀	Ω	1,66
Winding Inductance (Phase to Phase)	L	mh	16,5
Peak Current	I _{pk}	Arms	115,3
Continuos Current (Water Cooling Dt100)	I _{wc}	Arms	45,9
Continuos Current (Air Cooling Dt100)	I _{ac}	Arms	21,2
Stall Current at 0 Speed (Water Cooling)	I _{wsc}	Arms	35
Stall Current at 0 Speed (Air Cooling)	I _{sac}	Arms	16,2
Maximum Winding Temperature		°C	130
Height of Rotor		mm	50
Height of Stator		mm	130
Stator jacket outer diameter		mm	1030

Torque diagram

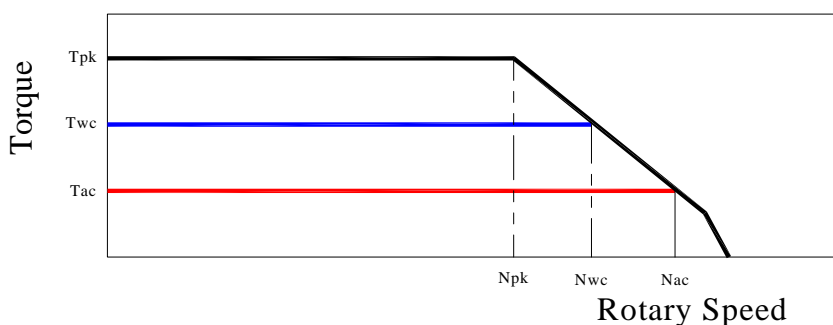

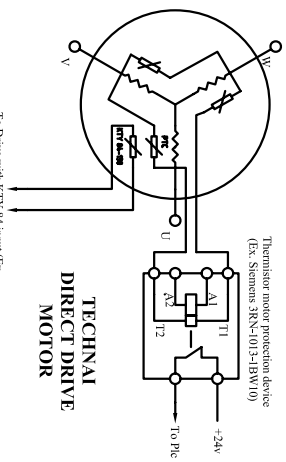
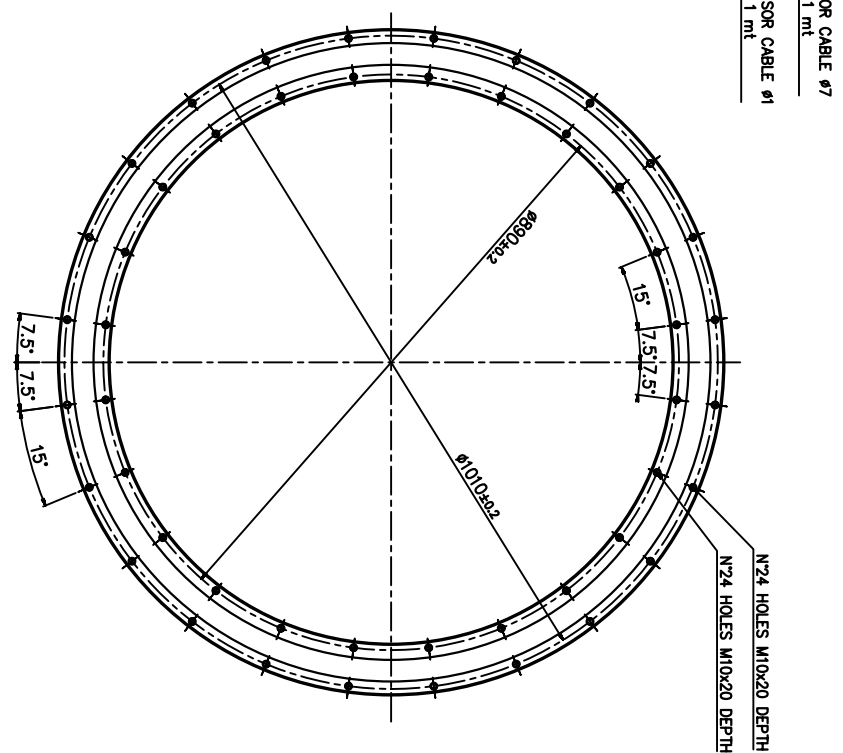
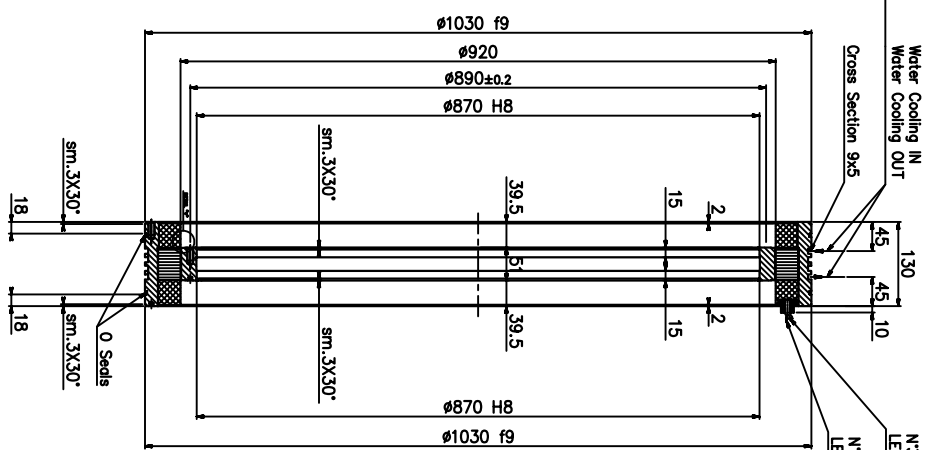
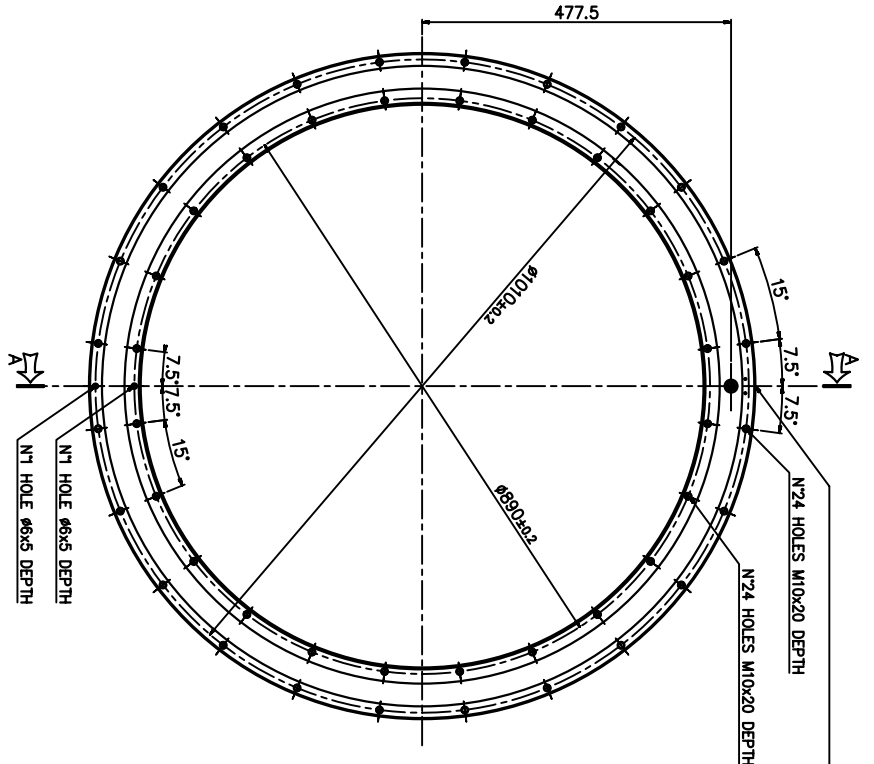

To Drive with KTY 84 input (Ex. Siemens SKN-10-3-BSW10) with the appropriate rating.

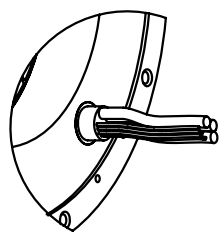

CABLE OUTPUT CONFIGURATION MF

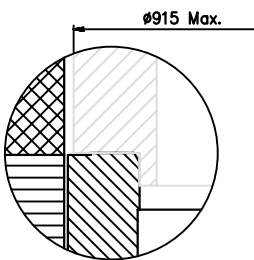

DETAIL "y-y"
ROTOR INTERFACE TO CUSTOMER SHAFT

TECHNAI		GENERAL ASSEMBLY	
ITEM NO.	REV.	DATE	BY
1			
TECHNAI ROTOR-STATOR KIT MK-CI 990			
MK-CI 990-050 MF			
SHEET 1 OF 1			

Projetada e desenvolvida em 3D - Reproduzida e distribuída, visto, não autorizada, exceto com a devida autorização escrita.

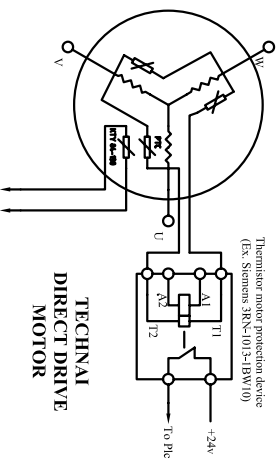
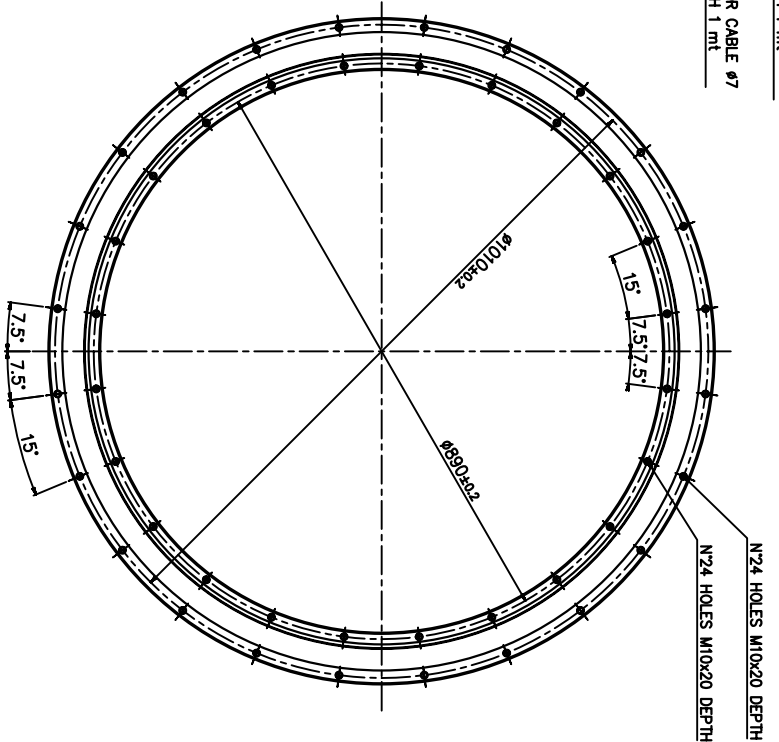
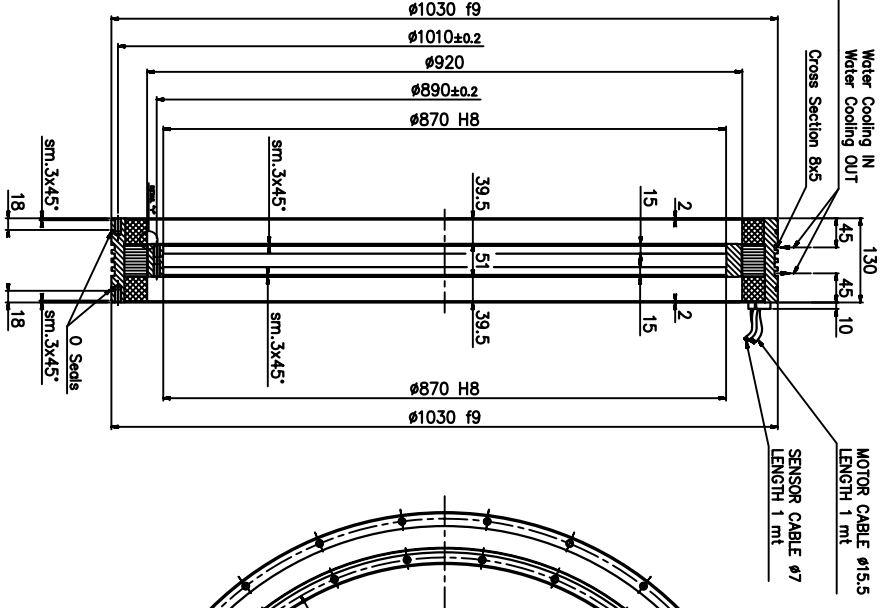
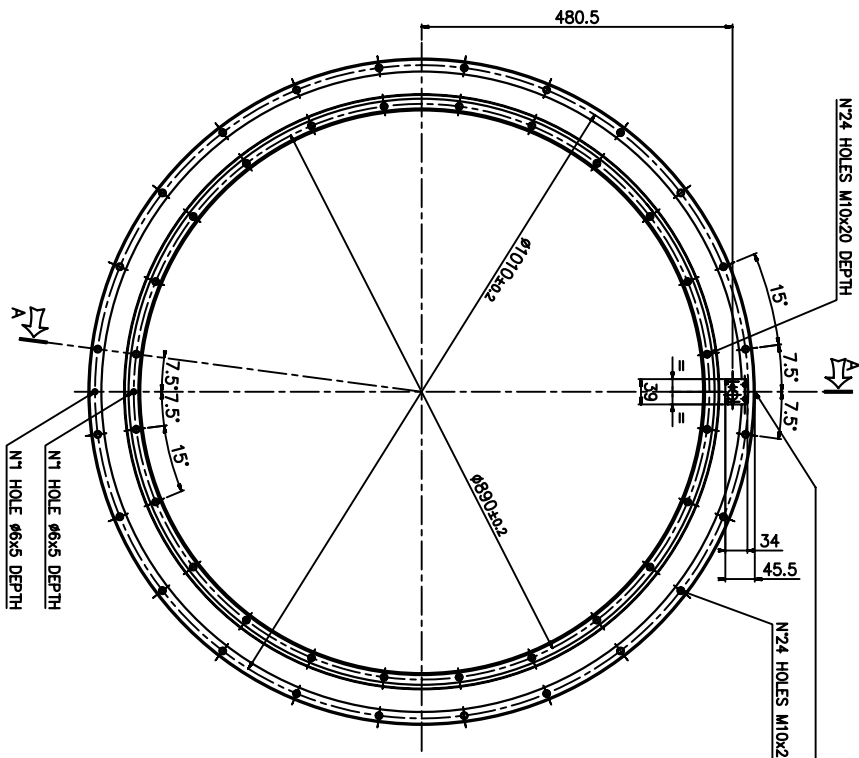

To Drive with KTY 84 input (Ex. Siemens SKS-10-18W110) or other suitable sensor with the appropriate rating.

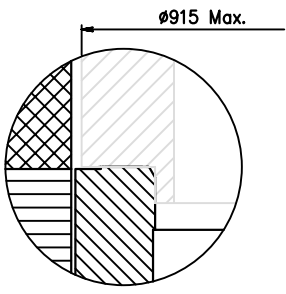
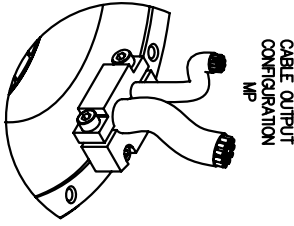

DETAIL "y-y"
ROTOR INTERFACE TO
CUSTOMER SHAFT

1. NAME	TECHNAI	GENERAL ASSEMBLY
2. MATERIAL		
3. MANUFACTURE		
4. DRAWING NUMBER	TECHNAI	
5. SCALE		
6. SHEET	1 OF 1	
7. CODE	MK-CI 990-050 MP	
8. DATE		
9. DRAWN BY		
10. CHECKED BY		
11. APPROVED BY		
12. REVISION		
13. COMMENTS		