

TORQUE MOTOR - MK-CI 560-100 WA

Motor specification	Symbol	Unit	
Number of pole	P		88
Peak Torque	T _{pk}	Nm	3800
Continuos Torque (Water Cooling Dt100)	T _{wc}	Nm	2084
Continuos Torque (Air Cooling Dt100)	T _{ac}	Nm	897
Stall Torque (Water Cooling)	T _{wsc}	Nm	1591
Stall Torque (Air Cooling)	T _{sac}	Nm	685
Ripple Torque (Cogging Torque)	T _r	Nm	24
Power Loss at T _{wc}	P _{wc}	Kw	8,3
Power Loss at T _{ac}	P _{ac}	Kw	1,7
Termal Resistance Water Cooling	R _{thWc}	Kw	0,12
Termal Resistance Air Cooling	R _{thAc}	Kw	0,06
Torque Constant	K _t	Nm/a	55,8
Back EMF Constant	K _e	V/1000 Rpm	3370
Maximum Speed at I _{pk} at 600 Vdc	N _{pk}	rpm	32
Maximum Speed at I _{wc} at 600 Vdc	N _{wc}	rpm	65
Maximum Speed at I _{ac} at 600 Vdc	N _{ac}	rpm	100
Winding Resistance (Phase to Phase)	R ₂₀	Ω	2,6
Winding Inductance (Phase to Phase)	L	mh	17,9
Peak Current	I _{pk}	Arms	99
Continuos Current (Water Cooling Dt100)	I _{wc}	Arms	39
Continuos Current (Air Cooling Dt100)	I _{ac}	Arms	16,7
Stall Current at 0 Speed (Water Cooling)	I _{wsc}	Arms	29,7
Stall Current at 0 Speed (Air Cooling)	I _{sac}	Arms	12,7
Maximum Winding Temperature		°C	130
Height of Rotor		mm	100
Height of Stator		mm	160
Stator jacket outer diameter		mm	600

Torque diagram

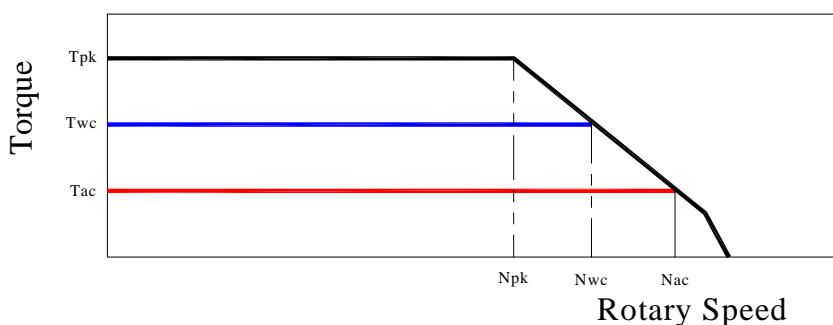

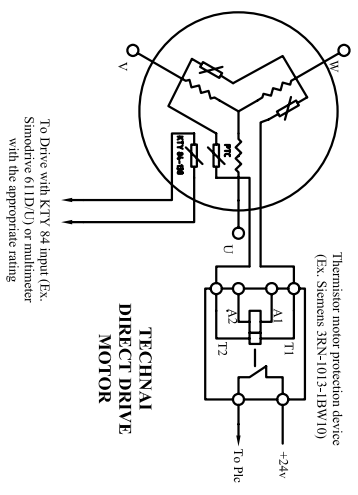
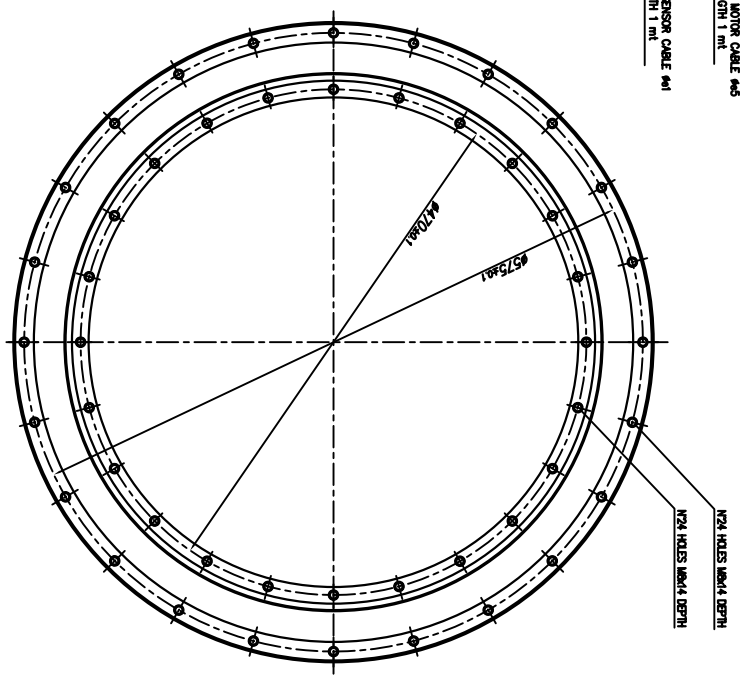
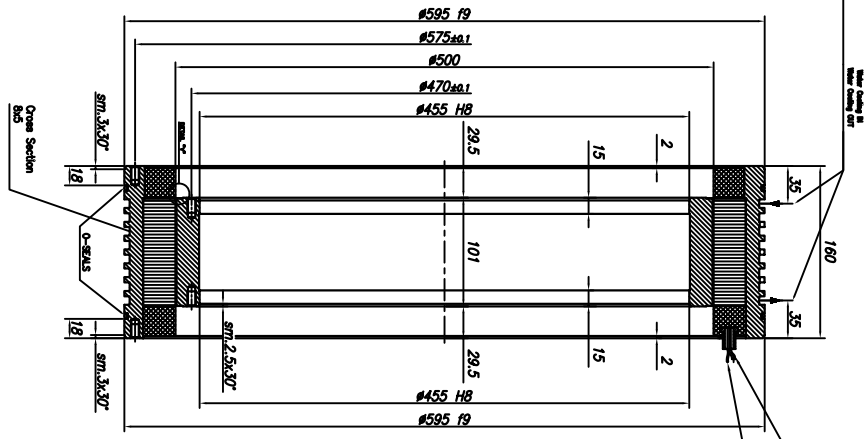
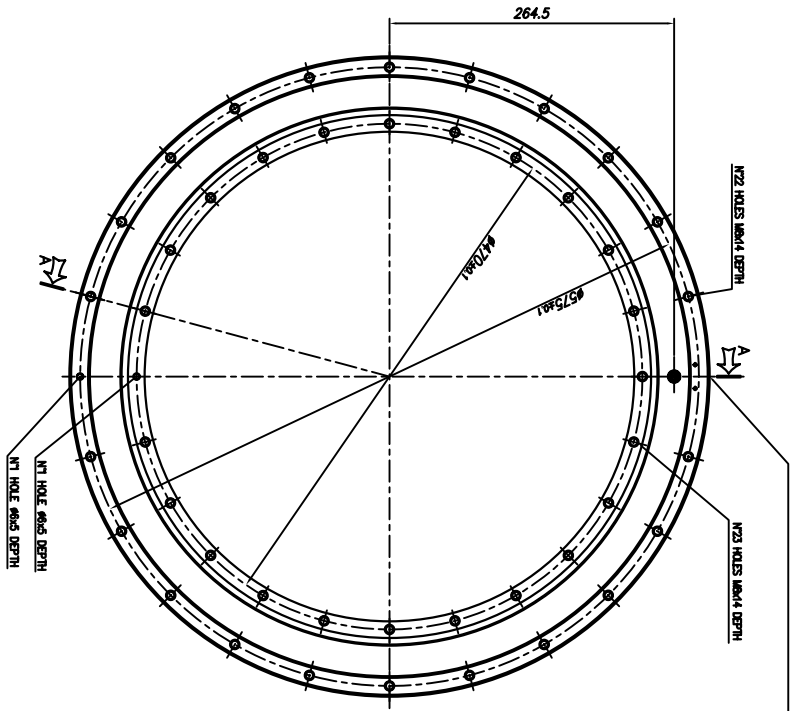

To Drive with KTY 84 input (Ex. Simodrive 611D(U) or multimeter with the appropriate rating)

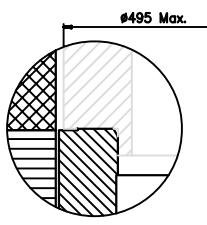
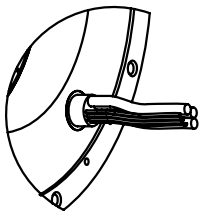

TECHNICAL		GENERAL ASSEMBLY	
ITEM NO.	REV.	DATE	BY
1			
MATERIAL		MATERIAL	
DESCRIPTION		DESCRIPTION	
QUANTITY		QUANTITY	
UNIT		UNIT	
SIZE		SIZE	
DRAWN		DRAWN	
CHECKED		CHECKED	
APPROVED		APPROVED	
DATE		DATE	
SHEET		SHEET	
1 OF 1		1 OF 1	
TECHNICAL		GENERAL ASSEMBLY	
ROTOR-STATOR KIT MK-CI 560		MK-CI 560-100 MF	
MK-CI 560-100 MF		MK-CI 560-100 MF	
SHEET		SHEET	
1 OF 1		1 OF 1	

Proprietà esclusiva di TECHNICAL Team s.r.l. - Riproduzione e diffusione vietata, senza autorizzazione scritta

