

## TORQUE MOTOR - MK-CI 420-030 WA

Motor specification	Symbol	Unit	
Number of pole	P		66
Peak Torque	T <sub>pk</sub>	Nm	430
Continuos Torque (Water Cooling Dt100)	T <sub>wc</sub>	Nm	283
Continuos Torque (Air Cooling Dt100)	T <sub>ac</sub>	Nm	128,5
Stall Torque (Water Cooling)	T <sub>wsc</sub>	Nm	216
Stall Torque (Air Cooling)	T <sub>sac</sub>	Nm	121
Ripple Torque (Cogging Torque)	Tr	Nm	3
Power Loss at T <sub>wc</sub>	P <sub>wc</sub>	Kw	2,7
Power Loss at T <sub>ac</sub>	P <sub>ac</sub>	Kw	0,5
Termal Resistance Water Cooling	R <sub>thWc</sub>	Kw	0,04
Termal Resistance Air Cooling	R <sub>thAc</sub>	Kw	0,17
Torque Constant	K <sub>t</sub>	Nm/a	24
Back EMF Constant	K <sub>e</sub>	V/1000 Rpm	1450
Maximum Speed at I <sub>pk</sub> at 600 Vdc	N <sub>pk</sub>	rpm	70
Maximum Speed at I <sub>wc</sub> at 600 Vdc	N <sub>wc</sub>	rpm	145
Maximum Speed at I <sub>ac</sub> at 600 Vdc	N <sub>ac</sub>	rpm	220
Winding Resistance (Phase to Phase)	R <sub>20</sub>	Ω	8,3
Winding Inductance (Phase to Phase)	L	mh	37,9
Peak Current	I <sub>pk</sub>	Arms	26
Continuos Current (Water Cooling Dt100)	I <sub>wc</sub>	Arms	12,6
Continuos Current (Air Cooling Dt100)	I <sub>ac</sub>	Arms	5,6
Stall Current at 0 Speed (Water Cooling)	I <sub>wsc</sub>	Arms	9,6
Stall Current at 0 Speed (Air Cooling)	I <sub>sac</sub>	Arms	4,3
Maximum Winding Temperature		°C	130
Height of Rotor		mm	30
Height of Stator		mm	90
Stator jacket outer diameter		mm	455

### Torque diagram

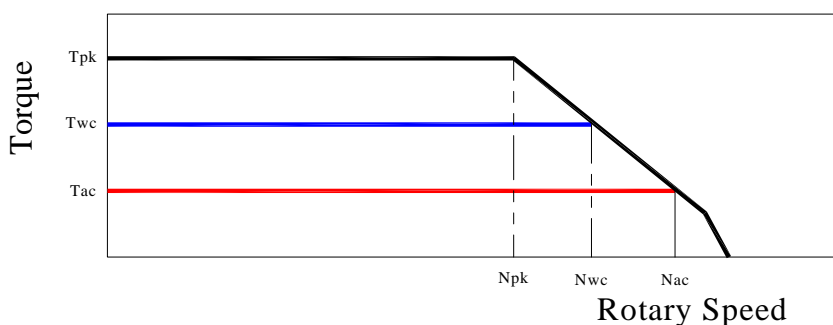

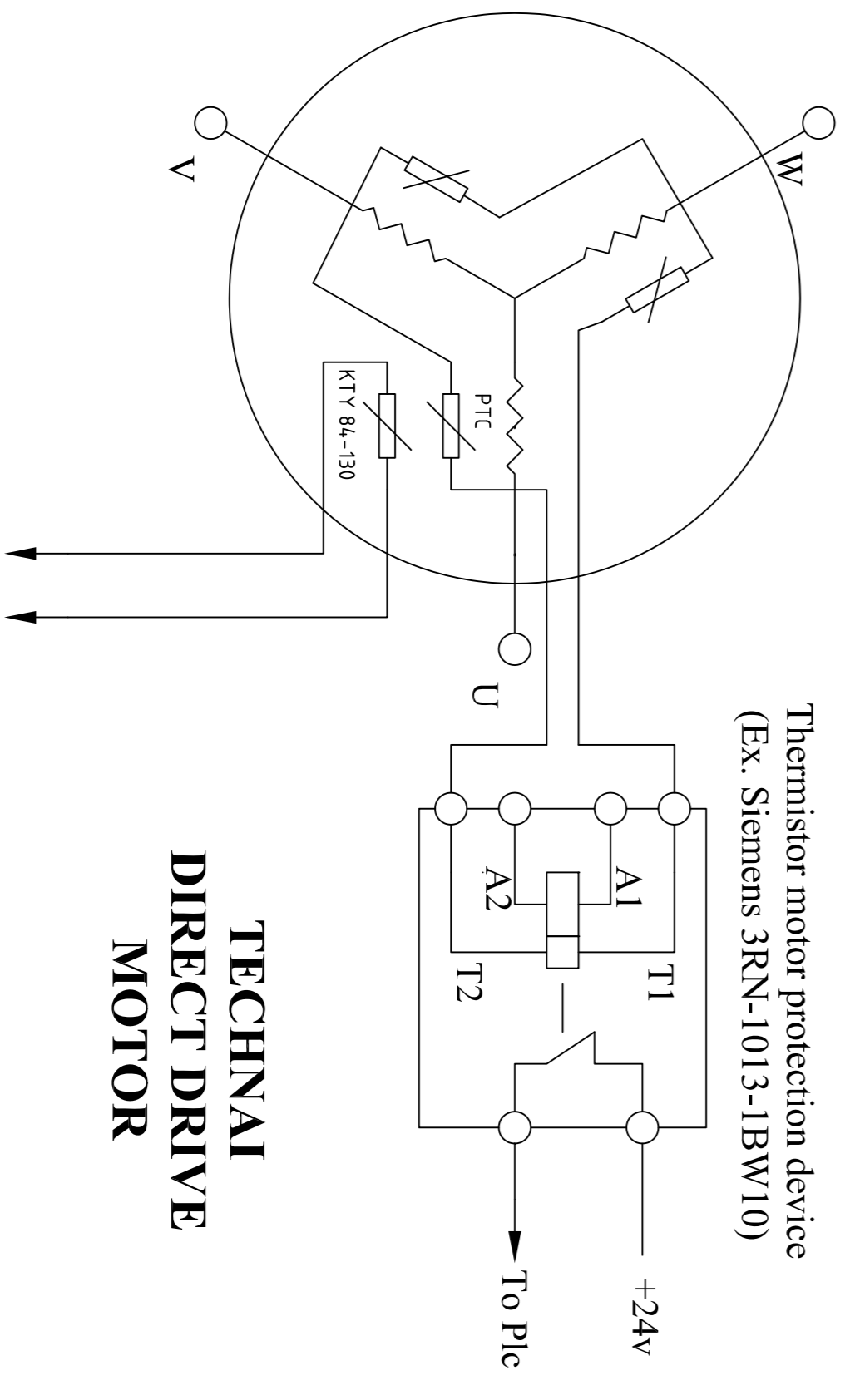
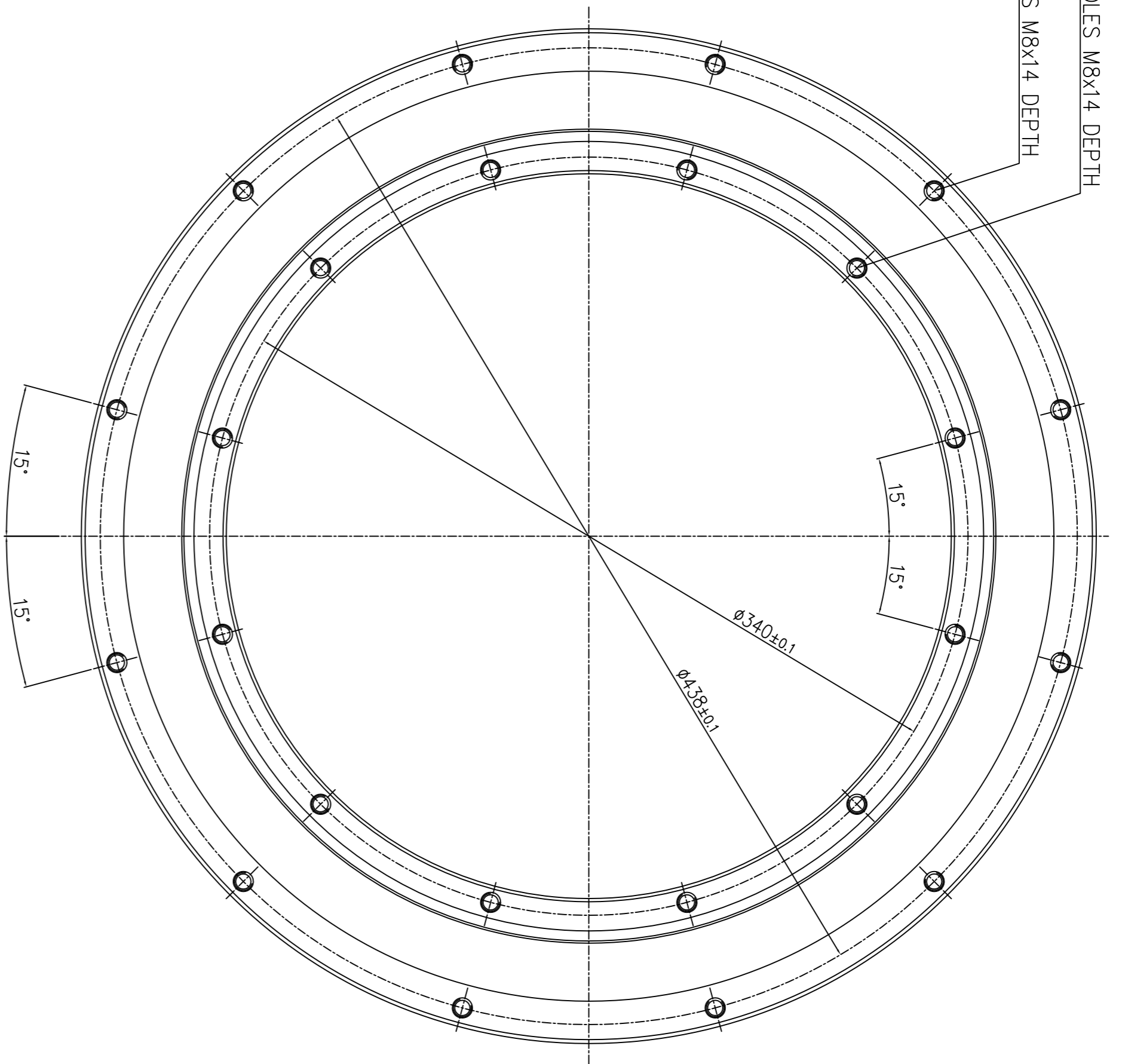
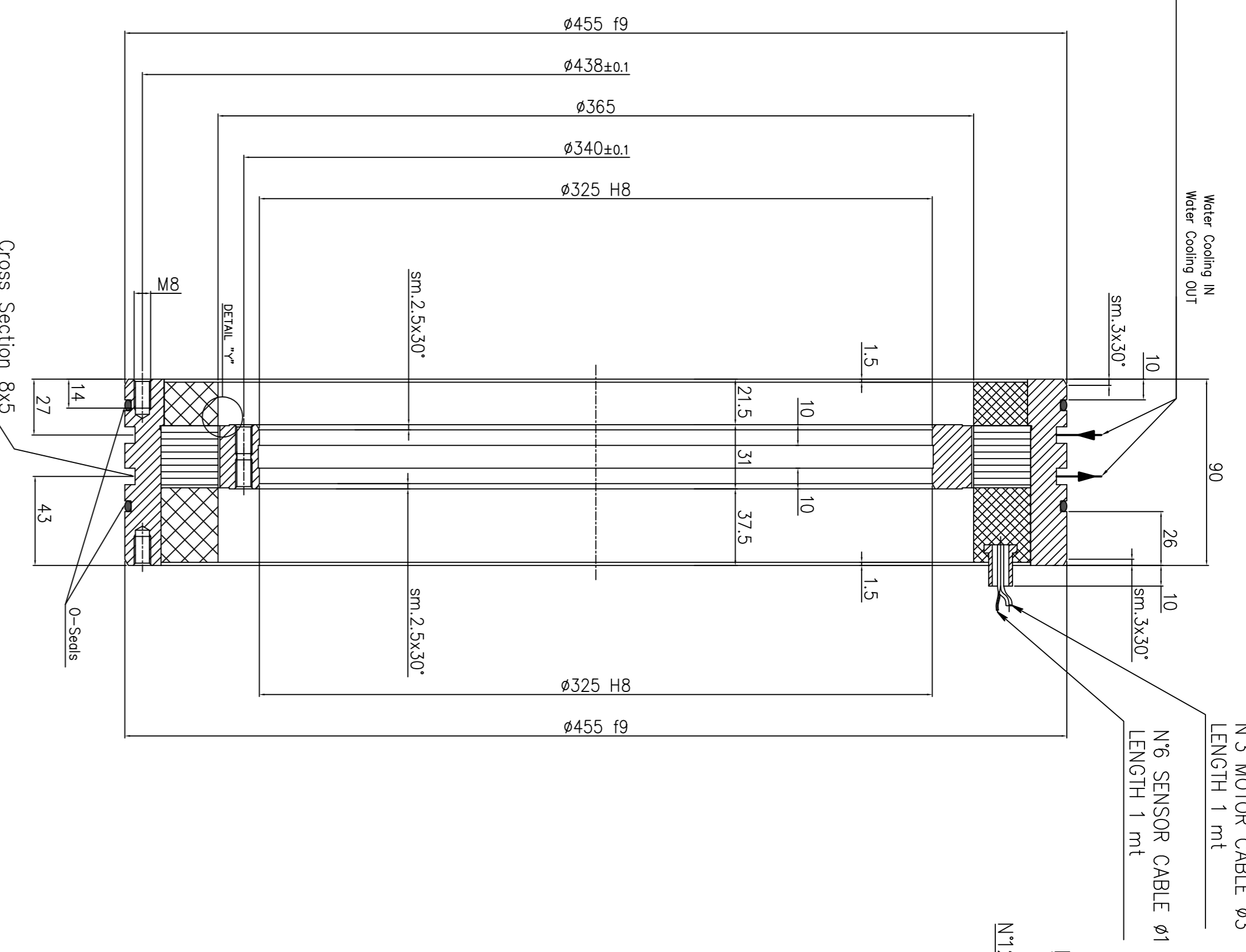
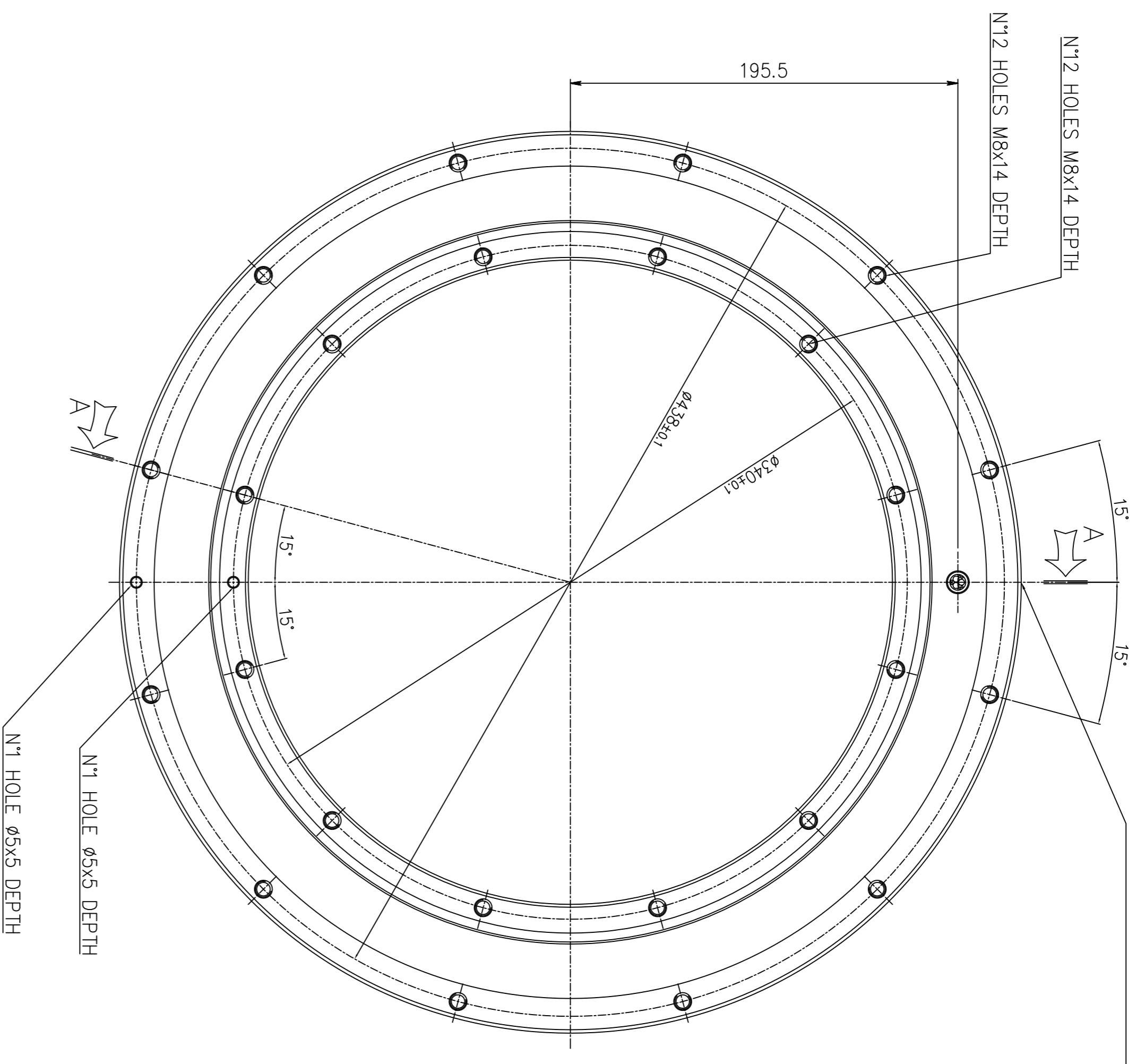

**TECHNAI  
DIRECT DRIVE  
MOTOR**

To Drive with KTY 84 input (Ex. Simodrive 611D/U) or multimeter with the appropriate rating

CABLE OUTPUT  
CONFIGURATION  
M/F

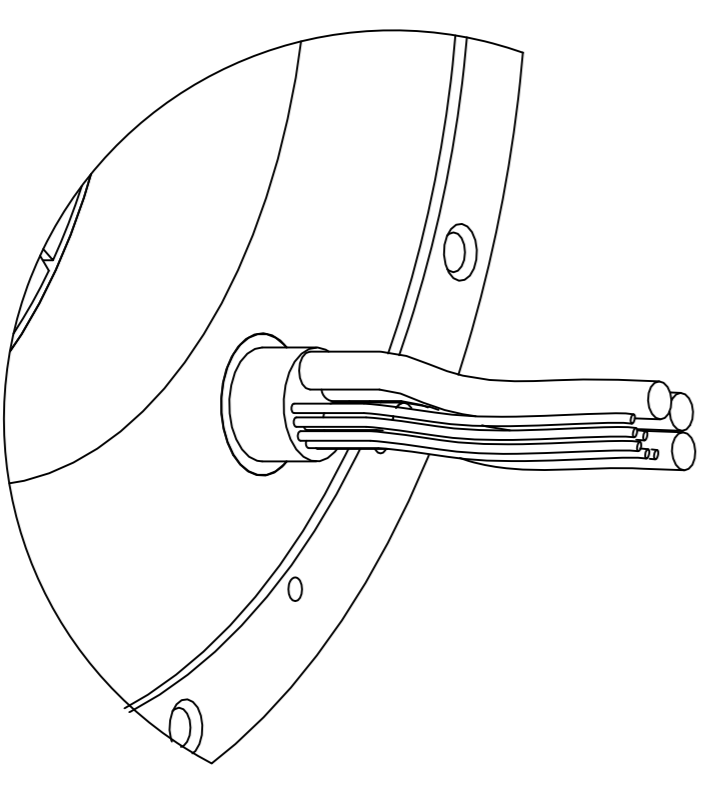

DETAIL "y"  
ROTOR INTERFACE TO  
CUSTOMER SHAFT

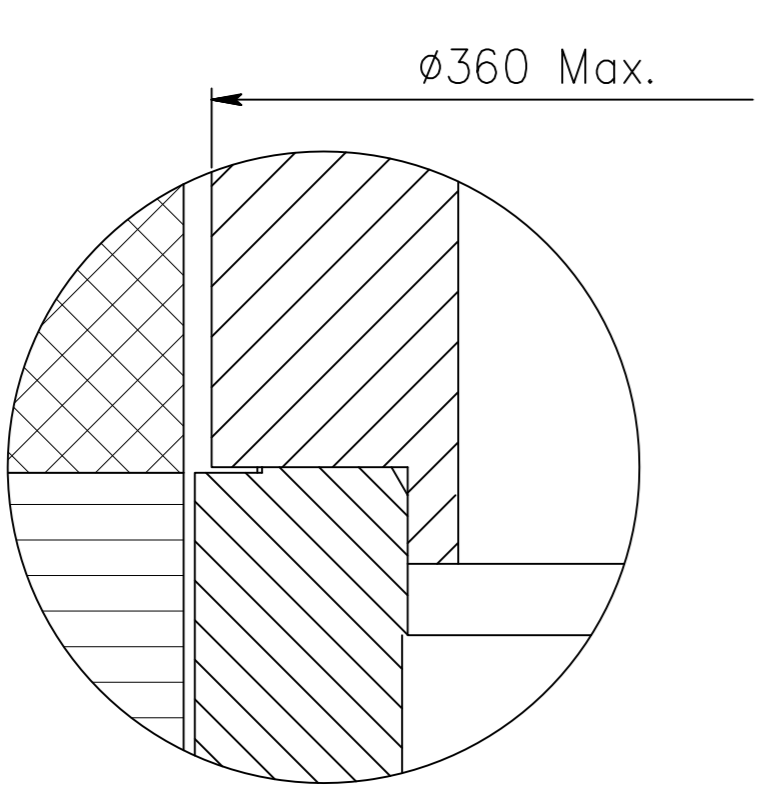

NO. UNIT	DESCRIZIONE	REVISIONE	DATA
1	ROTOR-STATOR KIT MK-CI 420	01	15/06/2009
<b>TECHNAI</b> GENERAL ASSEMBLY WORKING DIMENSIONS SCALE SHEET 1 of 1 COD. MK-CI 420-030 MF			

